

Because life is

PettyTM
Real

17 Pilgrim Street
Nelson
BB9 0JQ



For Sale

Price £115,000

- Spacious mid-terrace home arranged over three floors
- Convenient location close to local amenities and transport links
- Comfortable lounge to the front of the property
- Generous dining kitchen with space for a dining table
- Two well-proportioned first-floor bedrooms
- Three-piece bathroom suite on the first floor
- Large second-floor attic bedroom
- Far-reaching views across Nelson and the surrounding countryside from the attic room
- Ideal purchase for first-time buyers, families, or investors
- uPVC double glazing and gas central heating throughout



Situated in a convenient and well-established residential area of Nelson, this attractive mid-terrace home offers spacious accommodation arranged over three floors. Ideal for first-time buyers, young families, or investors, the property is well placed for local amenities, schools, transport links, and the nearby town centre.

The accommodation begins with a welcoming lounge, providing a comfortable space for relaxation and everyday living. Well-proportioned and filled with natural light, it provides an ideal setting for both relaxing and entertaining.

To the rear is a spacious dining kitchen, fitted with a range of units and offering ample room for a dining table and chairs. This sociable space is perfect for modern family living and provides access to the rear of the property.

The first-floor landing gives access to two well-proportioned bedrooms together with a three-piece bathroom suite. The rooms offer flexibility for a variety of uses, including children's bedrooms, guest accommodation, or a home office.

Occupying the second floor is a generous attic bedroom, enjoying far-reaching views across Nelson and towards the surrounding countryside. This versatile room provides excellent additional living space and could serve as a principal bedroom, guest suite, or workspace. Combining character, practicality, and impressive elevated views, this property presents an excellent opportunity for a wide range of purchasers.

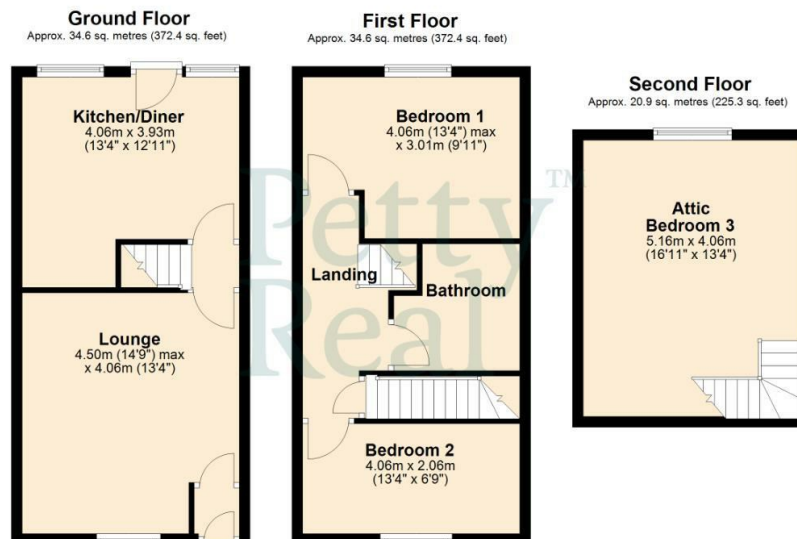

Total area: approx. 90.1 sq. metres (970.0 sq. feet)

All floorplans provided are for guidance only. Please check all dimensions before making any decisions reliant upon them.
Plan produced using PlanUp.



These particulars, whilst believed to be accurate are set out as a general outline only for guidance and do not constitute any part of an offer or contract. Intending purchasers should not rely on them as statements of representation of fact, but must satisfy themselves by inspection or otherwise as to their accuracy. No person in this firm's employment has the authority to make or give any representation or warranty in respect of the property.

11 Albert Road, Colne, Lancashire, BB8 0RY
T. 01282 868686
Colne.sales@pettyreal.co.uk

www.pettyreal.co.uk